

WORKSHOP on **Optical Illusions**

Project: **ONE POINT PERSPECTIVE** Landscape

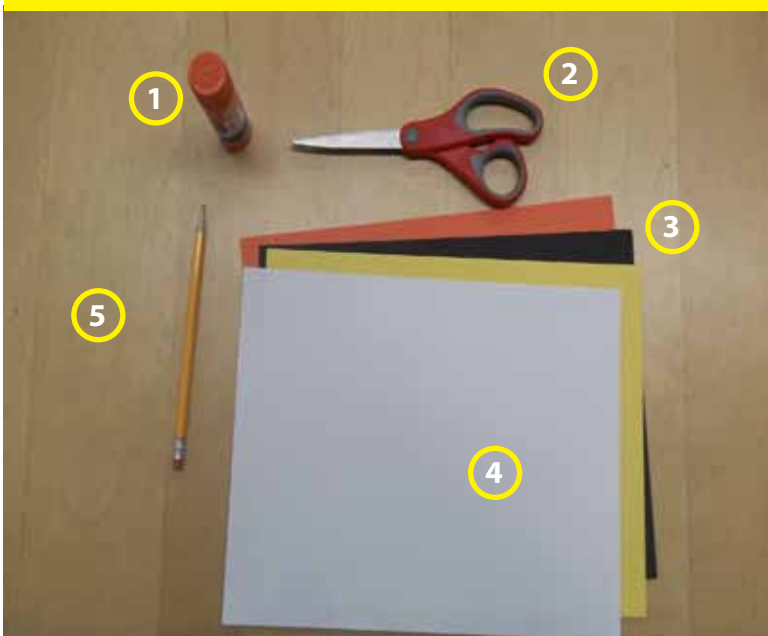

Parts (Materials and Tools):



- ① _____
- ② _____
- ③ _____
- ④ _____
- ⑤ _____

How to layout the guidelines on the paper:

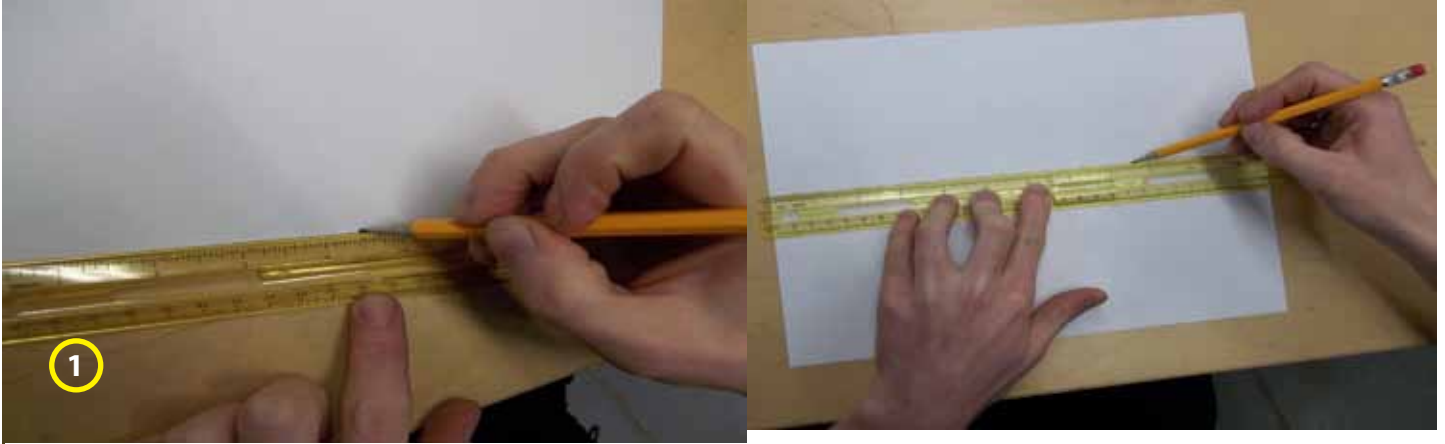

Find the middle point of the short sides, and draw a line across

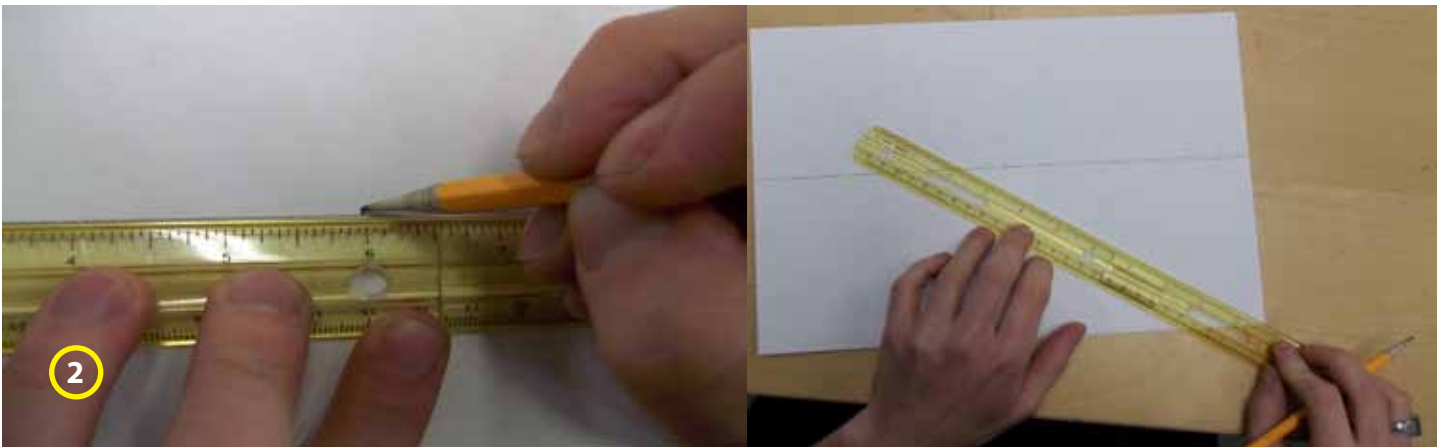

Find the middle point of the horizontal line

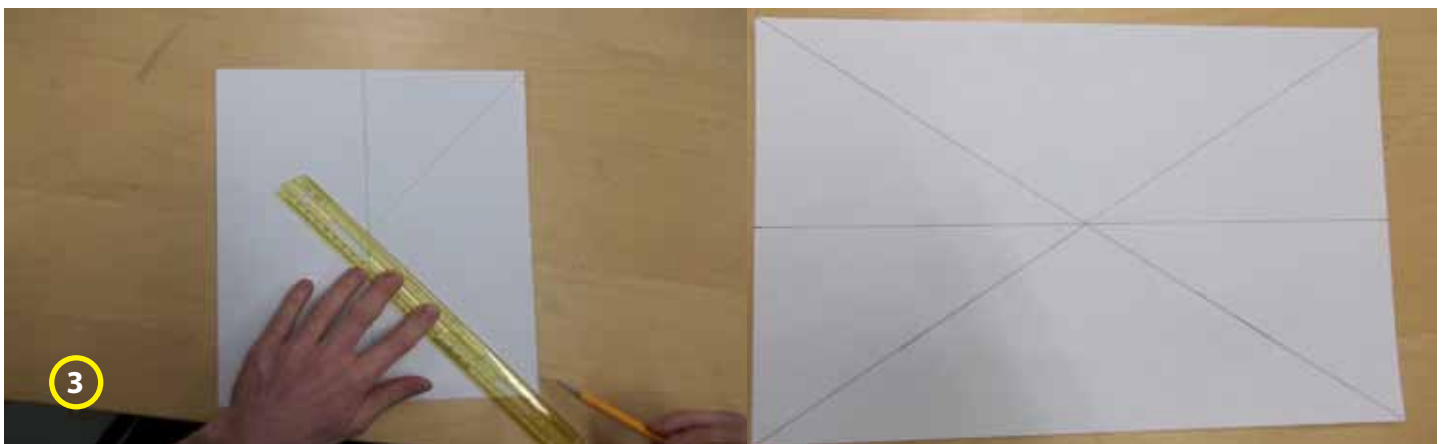

Draw lines from the center to each corner

Add paper sillouettes of different sizes

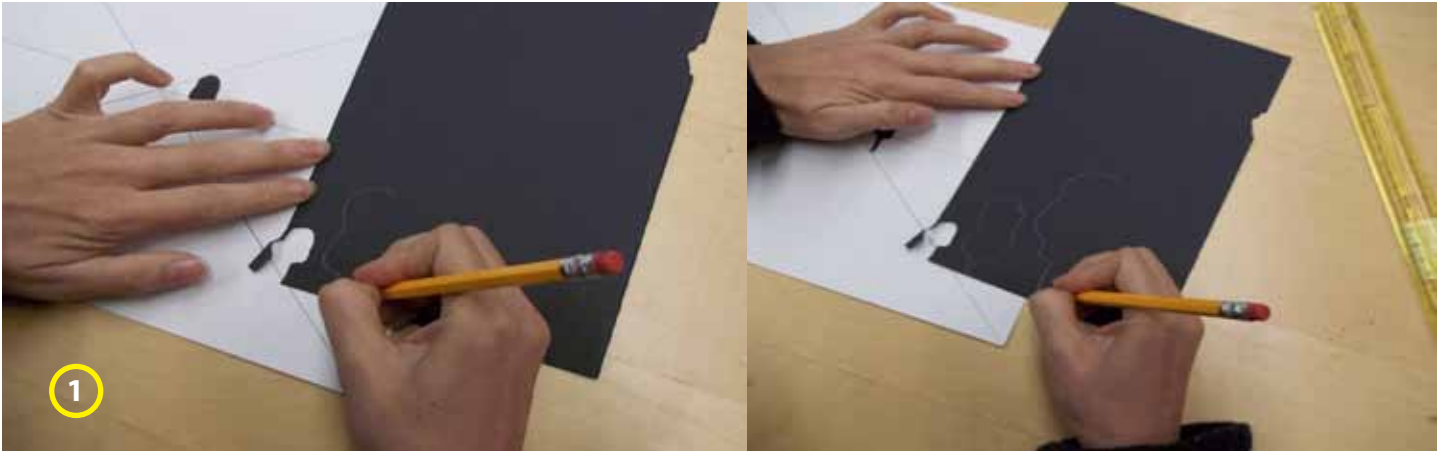

Draw a tree or other figure in several sizes.

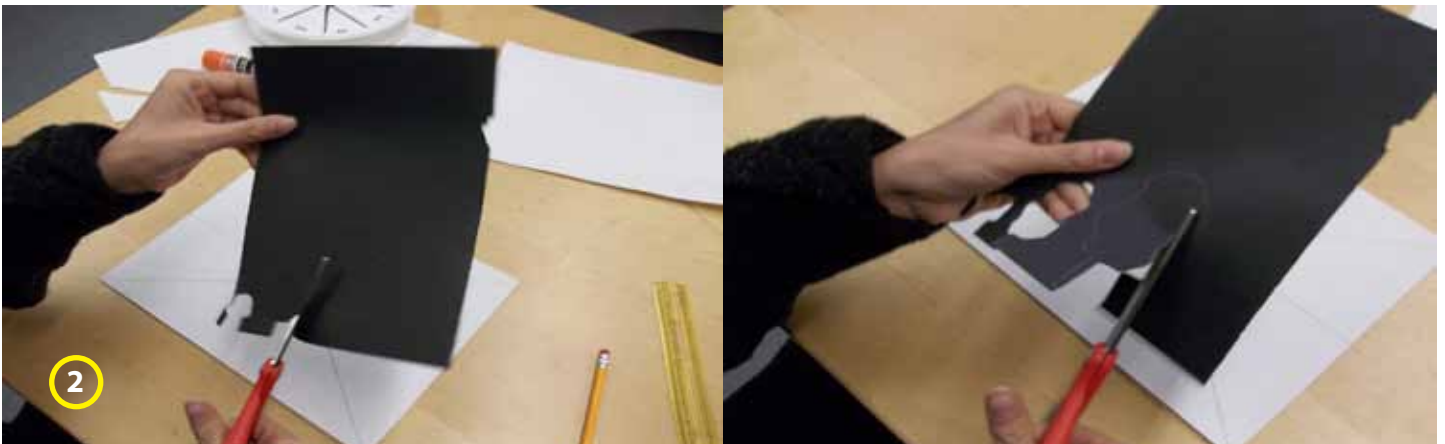

Cut out the figures.



Place the cutouts on the page so each fits between top and bottom lines.

You can also add more lines, to give the appearance of objects not directly in front.

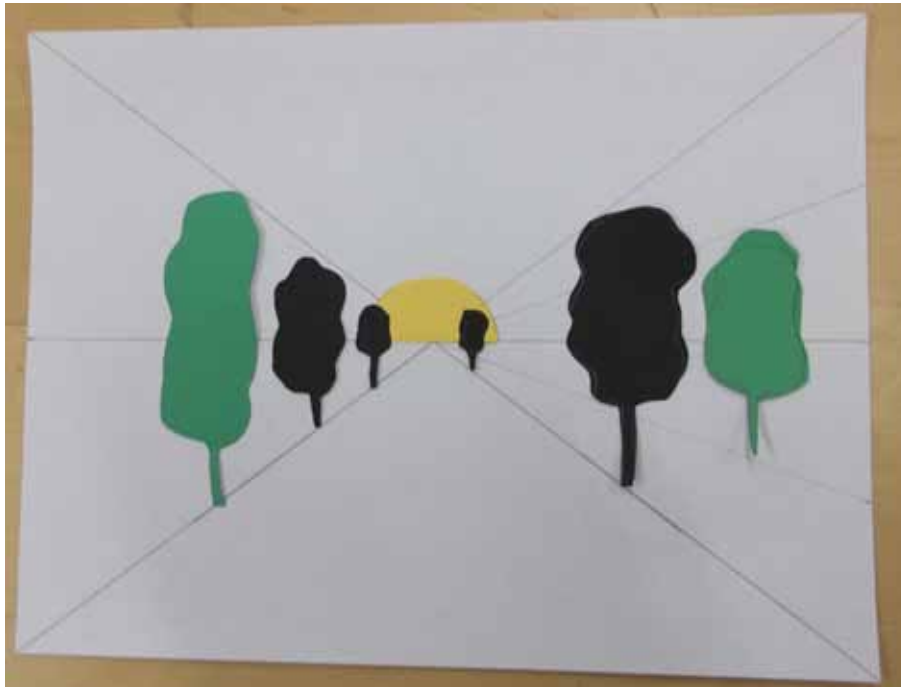

What did you learn from doing this project?